

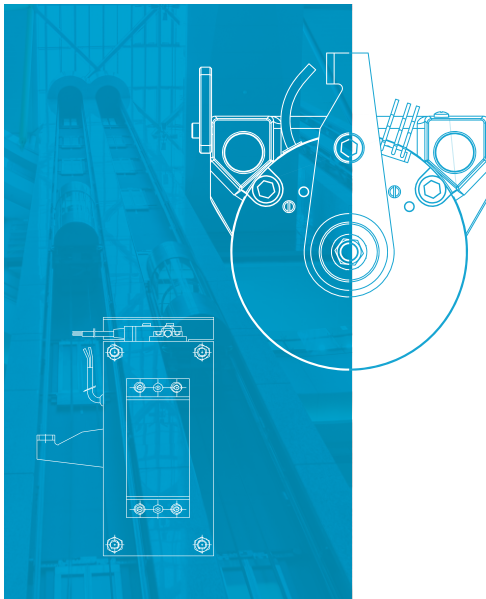

电梯曳引机安全制动器

*Safety Brakes
for Elevator Tractors*



成都瑞迪智驱科技股份有限公司
Reach Machinery Co., Ltd.

About REACH

关于瑞迪



成都瑞迪智驱科技股份有限公司创立于2009年，是一家致力于传动与制动系统关键零部件研发、生产与销售的高新技术企业。公司产品包括精密传动件、电磁制动器、谐波减速机 等，广泛应用于机器人、自动化生产线、电梯、风电、数控设备、起重机、塔吊、电动叉车、自动化立体停车库、高空平台车等自动化设备和高端装备制造领域。产品面向国内外销售，与全球多个行业头部和标杆企业形成了长期稳定的战略合作关系。

瑞迪始终坚持以技术为先导的战略发展模式，坚持诚信的质量理念，不断打造以结果和责任为中心的高效管理。瑞迪强调企业文化和核心价值观的影响力和渗透力，不断提高公司的凝聚力和市场的开拓能力。瑞迪的经营理念是通过向客户、市场、社会做出有价值的贡献，获得社会承认，通过技术、品质 和管理的领先，赢得自身的发展和壮大。

REACH MACHINERY CO., LTD, founded in 2009, is a high-tech enterprise dedicated to the R & D, production and sales of key components of transmission and braking systems. REACH's products include precision transmission parts, electromagnetic brakes, harmonic reducers, etc., which are widely used in the manufacturing fields of automation equipment and high-end equipment, such as robots, automatic production lines, elevators, wind power, numerical control equipment, cranes, tower cranes, electric forklifts, automatic three-dimensional parking garages, high-altitude platform vehicles, etc. The products are sold at domestic and abroad, and established a formed long-term and stable strategic cooperative relations with many industry leaders and benchmark enterprises around the world.

REACH MACHINERY CO., LTD have been insisted on the strategic development mode with technology as the guide, devoted us to the quality concept of integrity, and constantly creates an efficient management centered on results and responsibility. REACH emphasizes the influence and penetration of corporate culture and core values, and continuously improves the company's cohesion and market development ability. REACH's business philosophy is to gain social recognition through creating valuable contributions to customers, the market and the society, and to win its own development and expansion through leading technology, quality and management.

REB系列电磁制动器

REB Electromagnetic Brake

1 瑞迪是一家始终坚持以满足客户需求为基础,不断超越客户的期望值为理念的电磁制动器专业厂家,我们有着专业的研发团队、优秀的精益生产方式、先进的过程控制技术和强大的供应链配套能力。

In the field of electromagnetic brakes, REACH has always dedicated itself to satisfying customer demands and exceed their expectations. Combining the professional development team, optimized precision production, advanced process control technologies with cohesive supply chain, REACH pushes its technological creativity to its full potential to become a professional manufacturer.

2 拥有完善的研发测试能力,制程在线检测能力。

Complete R&D and testing capabilities, and online detection capability.

3 REB电磁制动器拥有瑞迪自主研发的阻尼减噪装置和优化的磁路设计,并选用进口微动开关。拥有多项发明专利,具有长寿命和低噪音的显著特点,噪音最低可达50dB(A)。

REB safety brakes are designed by integrating REACH's own damping devices for noise reduction and optimized design of electromagnetic circuits, It presents related patents granted to REACH and achieves high performance-price ratio and low noise, less than 50dB(A).



瑞迪的优势

Superiority

技术优势

- 专业的工程师队伍和多项制动器的专利体现出我们在电梯制动器领域的实力
- 客户需求为导向的设计理念,可为您提供定制解决方案
- 为多家行业顶尖客户提供优质产品,积累了大量行业和工况经验

Technical advantages

- Professional engineers and several patents of brakes,showing the Corpoation's strength in the filed of electromagnetic brakes for the elevator
- Customer demand-oriented design concept, provide customized solutions
- Longtime cooperated with industrial top customers, accumulated a lot of industry and application experiences

质量管理

- GB/T 19001-2016/ISO 9001:2015
- GB/T 24001-2016/ISO 14001:2015
- 推行六西格玛和TQM全面质量管理
- 独立的检测中心和齐全的检测设备
- 智能定子综合测试系统
- 磁通量测试仪
- 多功能摩擦材料测试机
- 静音室
- 磨损试验台
- 冲击测试仪

Quality management

- GB/T 19001-2016/ISO9001:2015
- GB/T 24001-2016/ISO 14001:2015
- Implement Six Sigma and TQM
- Independent inspection center and complete inspection equipments
- Intelligent Stator Integrated Test System
- Flux Tester
- Multi-functional Friction Materials Tester
- Test noise in Noise in Noise Room
- Abrasion Test Board
- Impact Tester



CONTENTS 目录

REB30系列弹簧加压电磁安全制动器 5

REB30 Spring-applied Safety
Electromagnetic Brake

REB31电梯曳引机电磁安全制动器 6

REB31 Safety Electromagnetic Brakes
for Elevator Traction

REB33电梯用盘式双倍低噪音电磁安全制动器 7

REB33 Double Disc Electromagnetic & Noise-Reduced
Brakes for Elevators

REB34系列多线圈双回路电磁制动器 9

REB34 Multi-pole Double-loop Electromagnetic brake

REB1014电梯曳引机钳盘式电磁安全制动器 10

REB1014 Caliper Electromagnetic Brake
for Elevator Tractor

REB30 系列弹簧加压电磁安全制动器

REB30 Spring-applied Safety Electromagnetic Brake

产品特点

- 采用螺钉安装, 使用维护简单
- 手动释放便于安装维护
- 间隙调整方便
- 无石棉摩擦片, 温升低、节能, 符合RoHS要求
- 微动开关、安装孔径大小可选

Product Features

- Use screw to install, easy application and maintenance
- Manual release for convenient installation and maintenance
- Gap adjustable
- None asbestos in friction plate, accord to ROHS Standard
- Optional installation bore diameter and microswitch

应用范围

- 自动扶梯
- 曳引机械
- 自动人行梯
- 提升设备

Application

- Escalator
- Traction Machinery
- Moving Sidewalk
- Lifting Device

技术参数

Technical Data

型号 Model	扭矩 Torque (N.m)	最大工作转速 Max. Work Speed (rpm)	安装孔径d Installation Pore Diameter (mm)	额定电压 Rated Voltage (V-DC)	额定功率 Rated Power (W)	重量 Weight (kg)
REB3016	130	4300	30	110	67.2	13
REB3018	180	3600	30/35	110	67.2	16.5

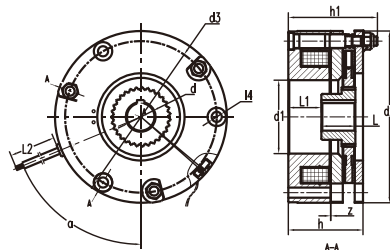

尺寸单位: mm

型号 Model	d1	d2	h	h1	d3	d4	z	L	L1	L2	a
REB3016	80	187	81.3	97	165	3-φ11	0.3	37	36	300	67.5
REB3018	80	215	86.4	107	186	3-φ13	0.3	40	35	300	65

REB31

电梯曳引机电磁安全制动器

REB31 Safety Electromagnetic Brakes for Elevator Traction

产品特点

- 安全性高: 采用独特的线圈设计,符合EN81、GB7588
- 温升低: 定子温升极低
- 扭矩大: 最大扭矩可以做到单个制动器扭矩1700N.m
- 噪音低: 独特的减噪技术,噪音最低可达50dB(A)
- 手动释放力矩低: 大扭矩下能轻松实现手动释放
- 微动开关可根据客户需求选配

Product Features

- High safety:use an unique coil to design conforming to EN81 and GB7588 standards
- Low temperature-rising:temperature of stators rises very low
- Large torque the maximum torque per brake is up to 1700N.m
- Low noise: Adopt unique noise reduction technology, the lowest noise can reach to 50dB(A)
- Low manual-releasing torque:the brake can be released manually in case of large torque
- Microswitch is optional based on customers requirement

应用范围

- 低层直梯曳引机
- 中高层直梯曳引机

Application

- Low floor straight elevator traction machine
- Middle or high floor straight elevator traction machine

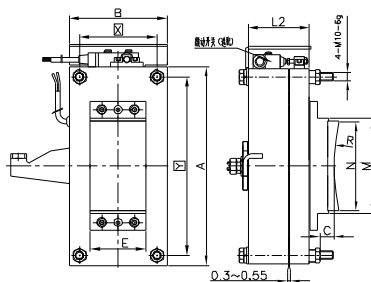

技术参数

Technical Data

系列 Series	扭矩 Torque (N.m)	A	B	X	Y	E	L2	M	N	R	C
3101	200~300	200	110	85	175	62	68	115	108	13~190	客户自定 Customer Requires
3101	600~750	245	120	95	220	68	76	118	110	180~230	客户自定 Customer Requires
3101	850~1000	250	126	95	220	68	80	118	110	200~230	客户自定 Customer Requires
3101	1000~1350	260	135	110	235	68	80	118	110	210~290	客户自定, 安装螺钉为4x12 Customer Requires

REB33

电梯用盘式双倍低噪音电磁安全制动器

REB33 Double Disc Electromagnetic & Noise-Reduced Brakes for Elevators

产品特点

- 安全性: 符合GB7588-2003和EN81相关规定
- 噪音低: 独特的安全减噪结构, 噪音低于55dB (A)
- 手动释放力矩低: 大扭矩下可以通过释放手柄轻松的释放制动器, 也可以通过远程松闸来实现释放
- 微动开关和安装尺寸可根据客户要求进行选择

Product Features

- Safety: comply with GB7588-2003 and EN81 standards
- Low Noise: less than 55db (A) with an unique noise- reduction mechanism
- Low manual-releasing torque: The brake can be released easily by release handle in case of large torque; it also can be released by remote system
- Optional installation bore diameter and microswitch

应用范围

- 中高层直梯曳引机

Application

- Middle or high floor straight elevator traction machine

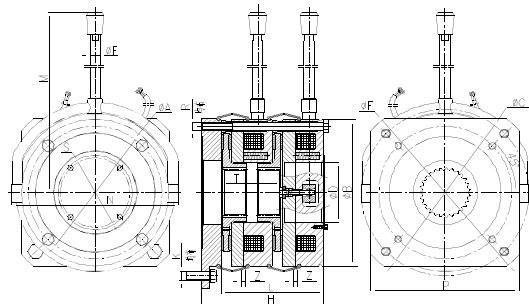

技术参数

Technical Data

规格 Specification	REB3314	REB3316	REB3318	REB3320	REB3325	REB3328
最大扭矩 Max. Torque (N·m)	2×60			2×800	2×1200	2×1600
最小扭矩 Min. Torque (N·m)		2×220	2×290	2×500	2×1000	2×1200
A (mm)	145	175	190	235	277	287
B (mm)	165	190	210	260	302	312
C (mm)	200	175	190	292	360	358
D (mm)	60	77	87	104	135	140
E (mm)	12	15	15			
F (mm)	220	190	210	324	410	394
H (mm)	160	160	170	219	236	230
L (mm)	135	146	156	193	201	203
M (mm)	250	360	360			
N (mm)	195	240	250			
P (mm)	170	190	210	264	360	315
S (mm)	80	客户指定 Customer Requires	100	120	150	150
T (mm)	70	85	90	107	110	110
Z (mm)	0.25~0.3	0.25~0.35	0.25~0.35	0.25~0.35	0.3~0.35	0.3~0.35
K	4×M10	6×M10	6×M10	4×M16	4×M20	4×M20
R	4×M8	4×M10	4×M10	6×M12	6×M12	6×M12

REB34

系列多线圈双回路电磁制动器

REB34 Multi-pole Double-loop Electromagnetic brake

产品特点

- 多线圈弹簧加压制动, 力矩为REB04系列的2倍
- 无石棉摩擦片, 温升高、节能, 符合RoHS要求
- 手动释放方式可选
- 微动开关、安装孔径大小可选
- 低噪音方式可选

Product Features

- Multi-pole spring-applied brake, Braking torque is as 2 times as REB04
- None asbestos in friction plate, accord to ROHS Standard
- Optional manual-releasing
- Optional installation bore diameter and microswitch
- Optional low-noise design

应用范围

- 电梯曳引机
- 制动电机
- 仓储设备

Application

- Elevator Tractor
- Braking Motor
- Warehousing Facilities

技术参数

Technical Data

型号 Model	扭矩 Torque (N.m)	最大工作转速 Max. Work Speed (rpm)	安装孔径d Installation Pore Diameter (mm)	额定电压 Rated Voltage (V-DC)	保持功率 Sustaining Power(W)	过励磁功率 Overexcited Power(W)
REB3418	2×225	3000	35/40/45	205/103V	2×51	2×204
REB3420	2×280	3700	35/40/45/50	205/103V	2×51	2×204
REB3422	2×300	3000	35/40/45/50	205/104V	2×66	2×264
REB3425	2×610	3000	40/45/50/55/60/65	205/103V	2×66	2×264

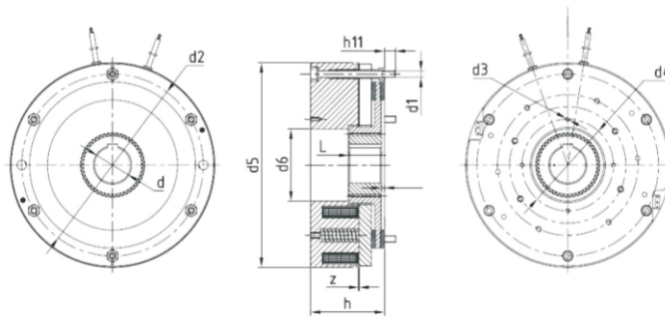

尺寸单位: mm

型号 Model	d1	d2	d3	d4	d5	d6 ^{H8}	h	h11	L	z
REB3418	6×M8	196	4×M6	110	235	66	82.5	15.5	40	0.3
REB3420	6×M10	230	4×M6	110	260	85	80	15.5	40	0.3
REB3422	6×M8	229	4×M6	110	260	66	84	12.8	40	0.3
REB3425	6×M10	278	4×M6	140	315	115	94.5	17	50	0.3

REB1014

电梯曳引机钳式电磁安全制动器

REB1014 Caliper Electromagnetic Brake for Elevator Tractor

产品特点

- 采用螺钉安装,使用维护简单
- 手动释放便于安装维护
- 微动开关可选
- 无石棉摩擦片,符合RoHs要求
- 低噪音设计,工作噪音小于55dB(A)
- 模块化设计

Product Features

- Use screws to install with easy application and maintenance
- Easily to be installed and maintained by manually release
- Optional microswitch
- None asbestos in friction plate, accord to ROHS Standard
- Low noise design, less than 55db in working
- Modularized design

应用范围

- 自动扶梯
- 自动人行梯
- 曳引机械
- 提升设备

Application

- Escalator
- Moving Sidewalk
- Traction Machinery
- Lifting Device

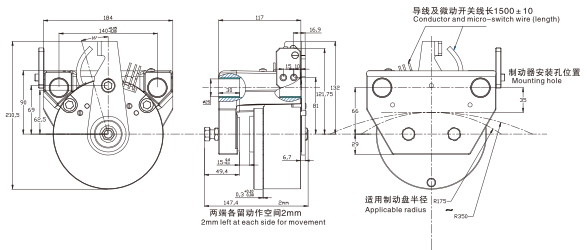
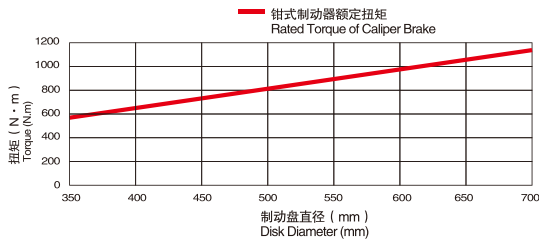

技术参数

Technical Data

型号 Model	电压 Voltage		电流 Current		功率 Power		扭矩 Torque
	保持电压 Sustaining Voltage	过励磁电压 Over-excitation Power	保持电流 Sustaining Current	过励磁电流 Over-excitation Current	保持功率 Sustaining Power	过励磁功率 Over-excitation Power	制动盘直径相关 See Diameter of Brake Disc
REB1014A	24VDC	48VDC	1.7A	3.3A	40W	160W	见下图 See following diagram
REB1014B	52VDC	103.5VDC	0.85A	1.7A	44.5W	176W	见下图 See following diagram
REB1014C	99VDC	198VDC	0.416A	0.832A	41.2W	164W	见下图 See following diagram

产品动作时间

Product operation time

衔铁释放时间：从断开电流至衔铁恢复到吸引前位置的时间。

衔铁吸引时间：从电流开始流动至衔铁完全被吸引的时间。

The armature releasing time: from the current turn-off to the armature's return to the position before pulling.

The armature pulling time: from the current turn-on to the armature's full pulling.

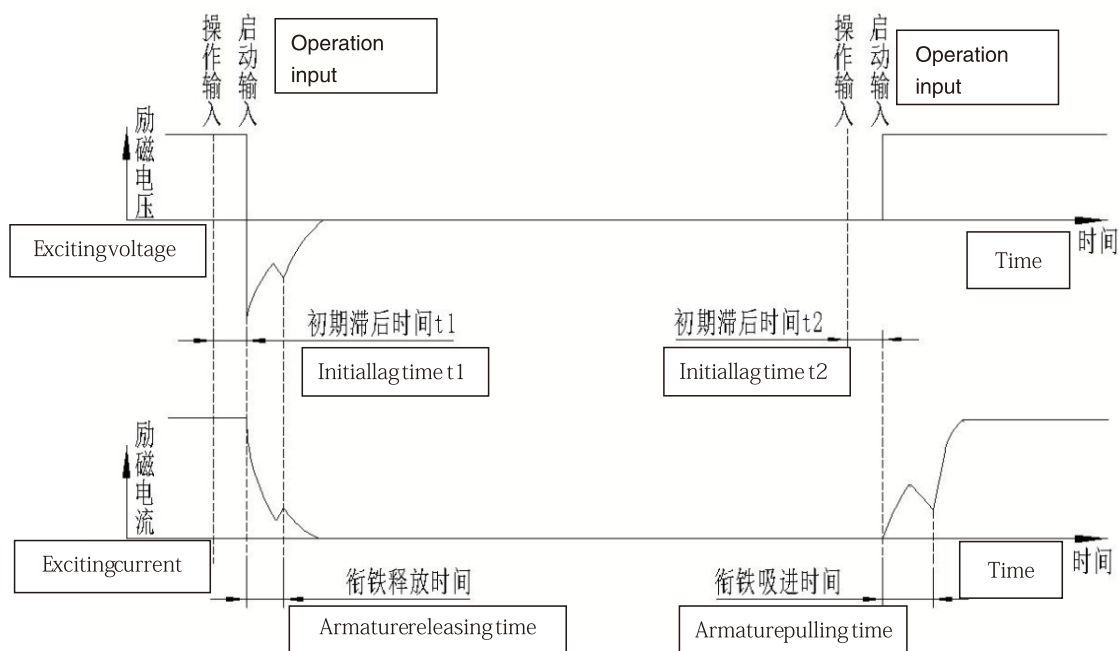



Phone: 400-090-7210

Site: www.reachgroup.cn

Add: 四川省成都市双流区西航港大道中四段909号

Add: NO.909 Middle Section 4, West Airport Ave, Southwest Airport Economic Development Zone, Shuangliu Region, Chengdu, Sichuan Province China

版本号: ZH-20210401